

**IDEJNO REŠENJE
ENTERIJERA
KOMUNIKACIJA**

TC "KALČA" NIŠ

ARHITEKTURA I DEKOR STUDIO

OSNOVA PRIZEMLJA- DEMONTAŽE I RUŠENJA

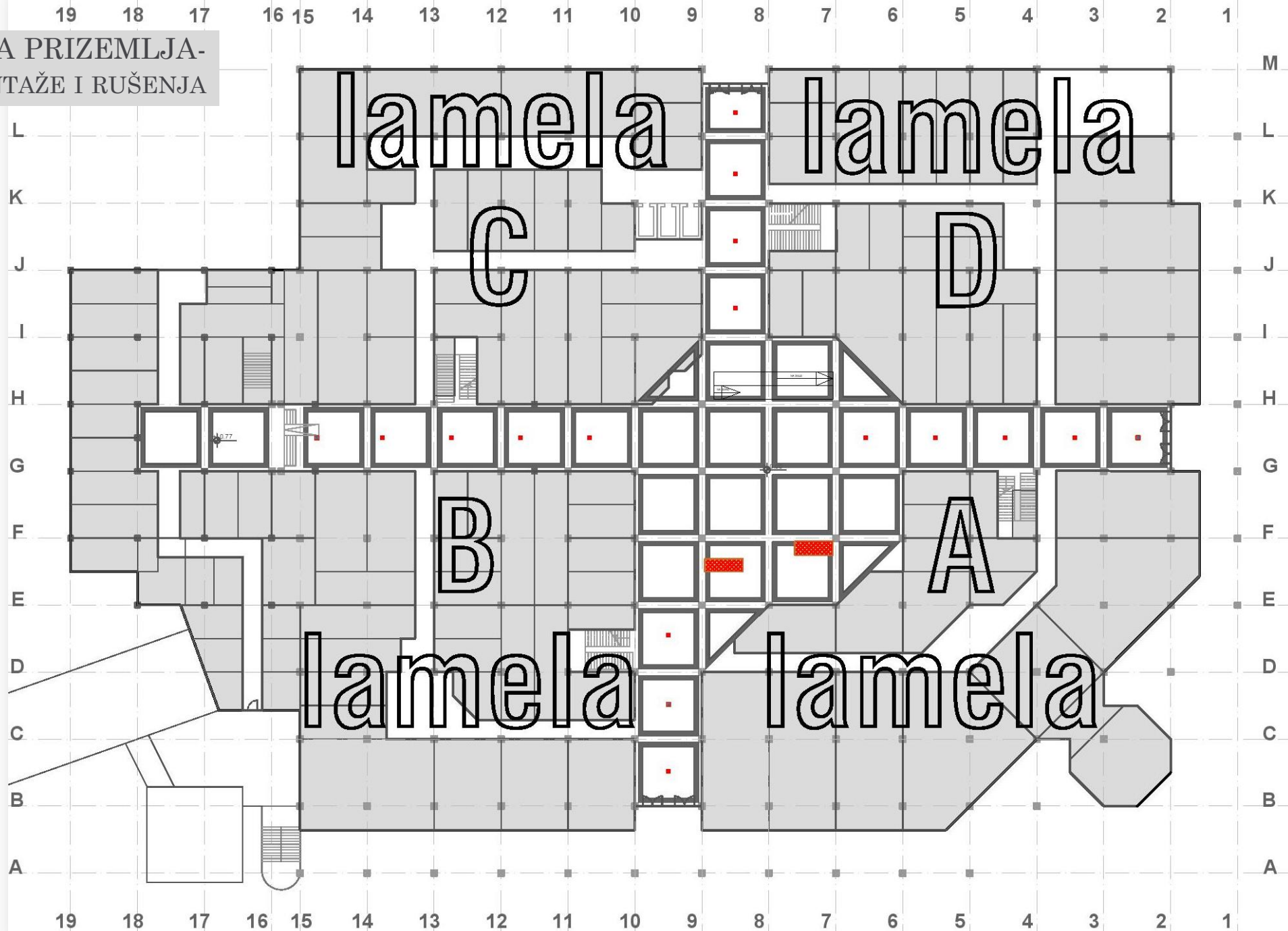

OSNOVA PRIZEMLJA

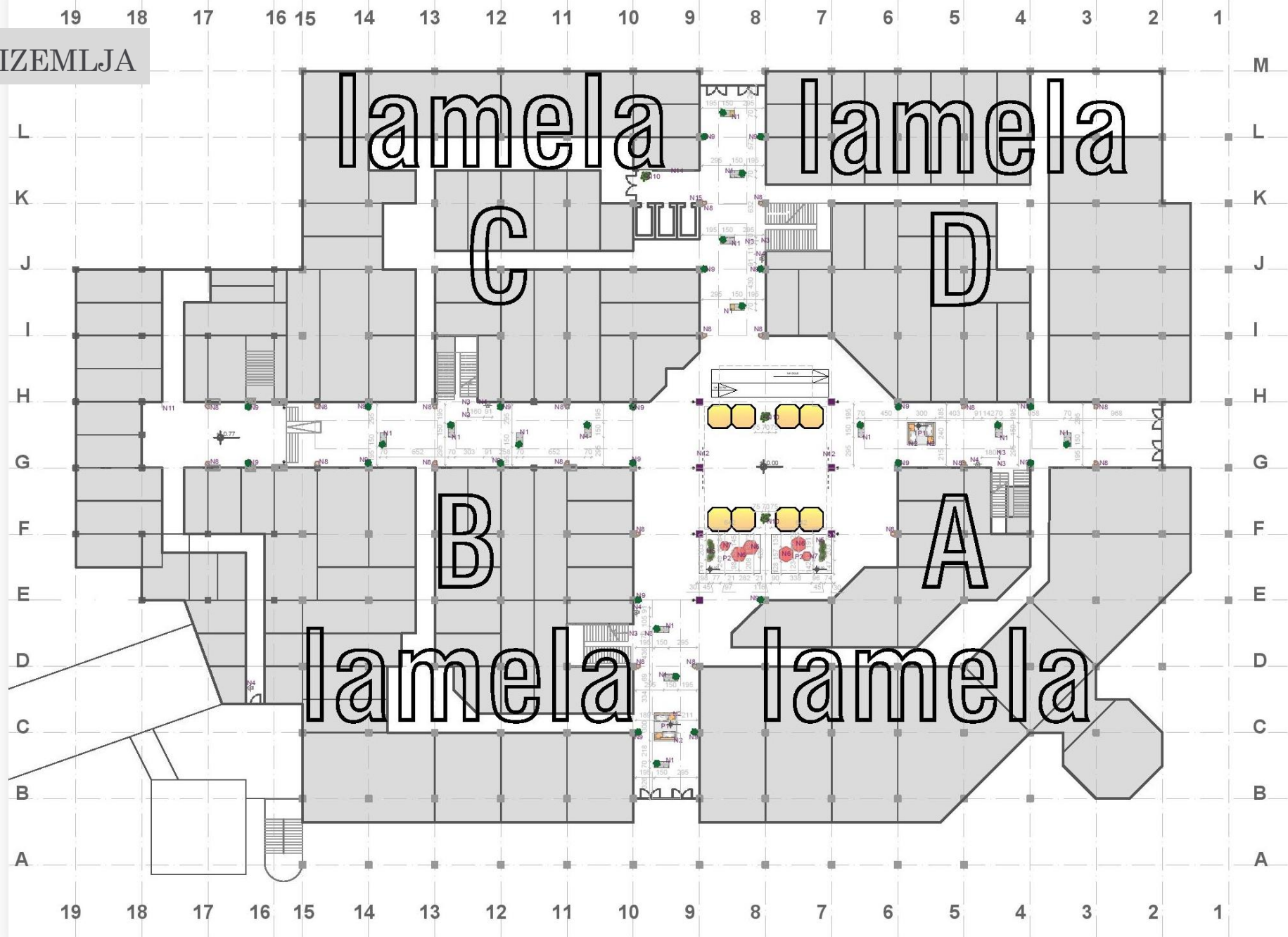

- N1 Klupa sa zelenilom
- N2 Prodajni punkt
- N3 Orientaciona tabla
- N4 Orientaciono-reklamni elementi
- N5 Žardinjera
- N6 Element za sedenje
- N7 Element za sedenje
- N8 Kanta za smeće
- N9 Žardinjera
- N10 Žardinjera
- N11 Orientaciona tabla
- N12 Reklamni bilbord 440x300 cm
- N13 Dekorativni skrivač spoljne jedinice klime
- N14 Oglasni pano
- N15 Orientaciona tabla
- Zidne svećiljke Eglo Simione 97285
- Postojeće stubove obložiti gips karton pločama na leplju sa obaveznim bandažiranjem spojeva ugaonim lajsnama. Postavljanje tapete 365754 A.S. Designschunge! by Laura N.
- P1 Platforma sa prodajnim punktovima
- P2 Platforma sa elementima za sedenje



OSNOVA I SPRATA

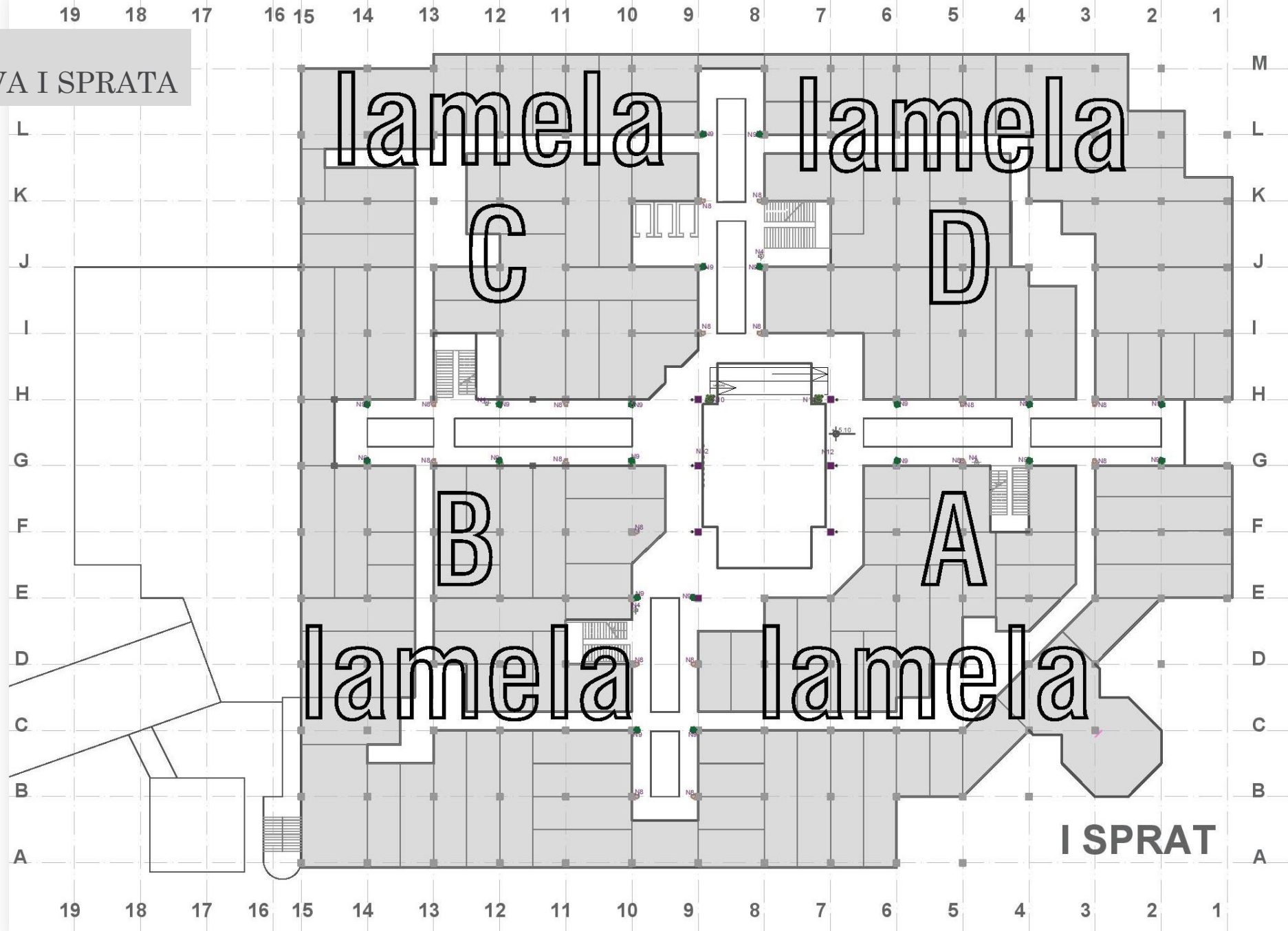

- N4 Orijentaciono-reklamni element
- Kanta za smeće
- N8 Žardinjera
- N10 Žardinjera
- N12 Reklamni bilbord 440x300 cm
- Zidne svećiljke Eglo Simione 97285
- Postojeće stubove obložiti gips karton pločama na lepku, sa obaveznom bandažiranjem spojeva ugaonim lajsnama. Postavljanje tapete 365754 A.S. Designschungel by Laura N.



OSNOVA II SPRATA

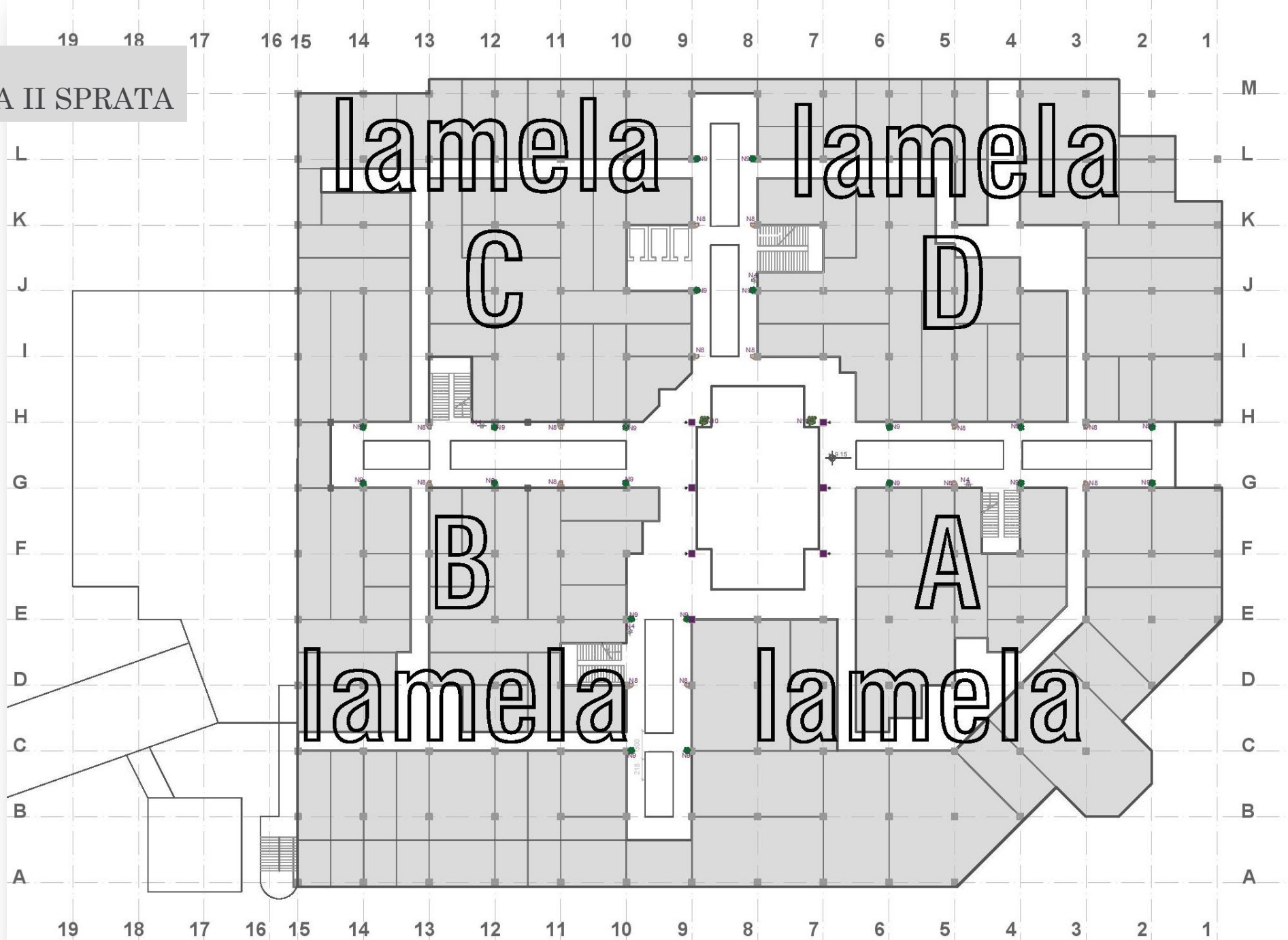

- N4 Orientaciono-reklamni element
- N8 Kanta za smeće
- N9 Žardinjera
- N10 Žardinjera
- Zidne svetiljke Eglo Simone 97285
- Postojeće stubove obložiti gips karton pločama na lepku, sa obaveznim bandažiranjem spojeva ugaonim ljestinama. Postavljanje tapete 365754 A.S. Designschungel by Laura N.



OSNOVA PLAFONA PRIZEMLJE

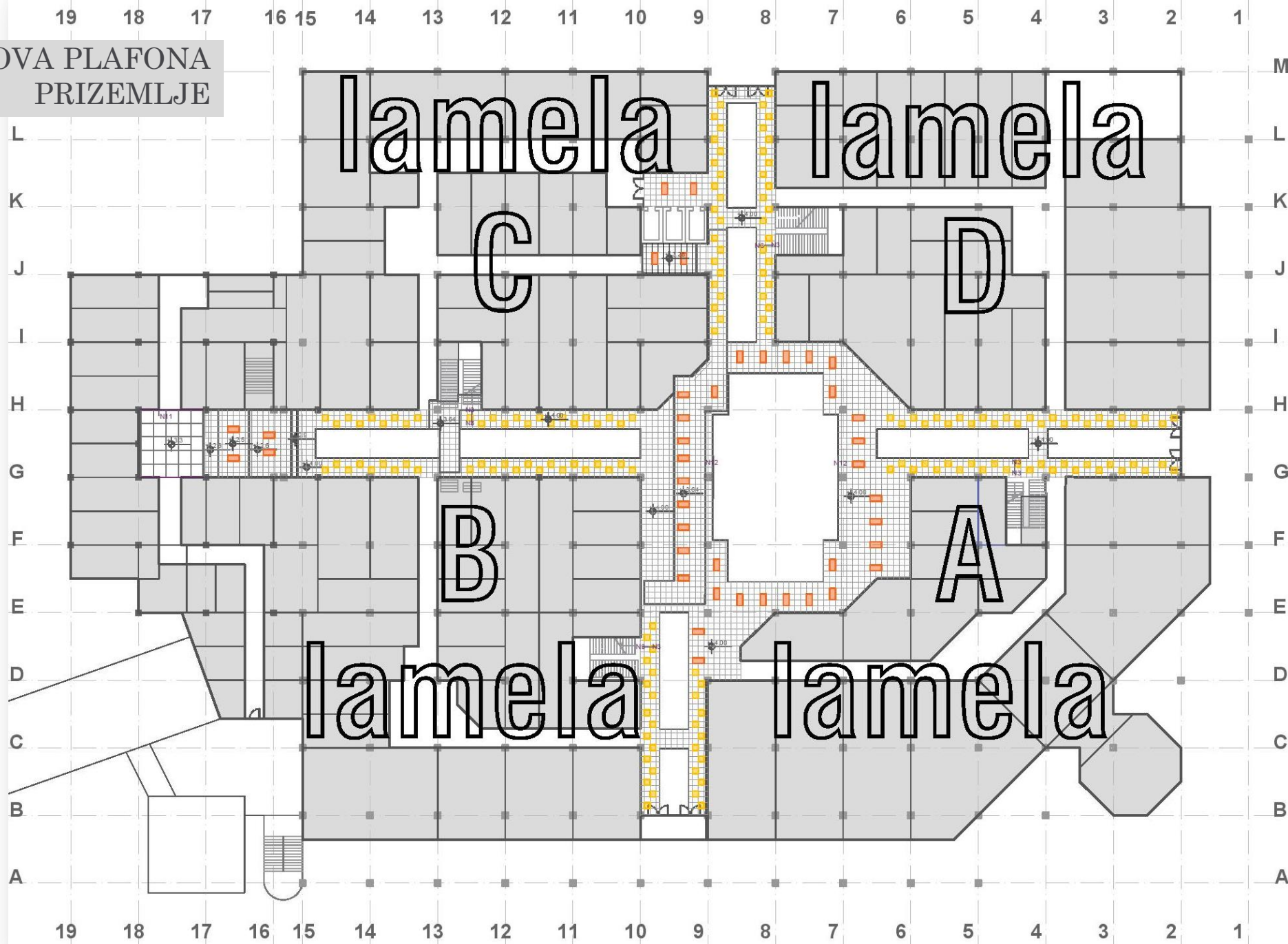

OSNOVA PRIZEMLJA- OBRADA ZIDNIH POVRŠINA

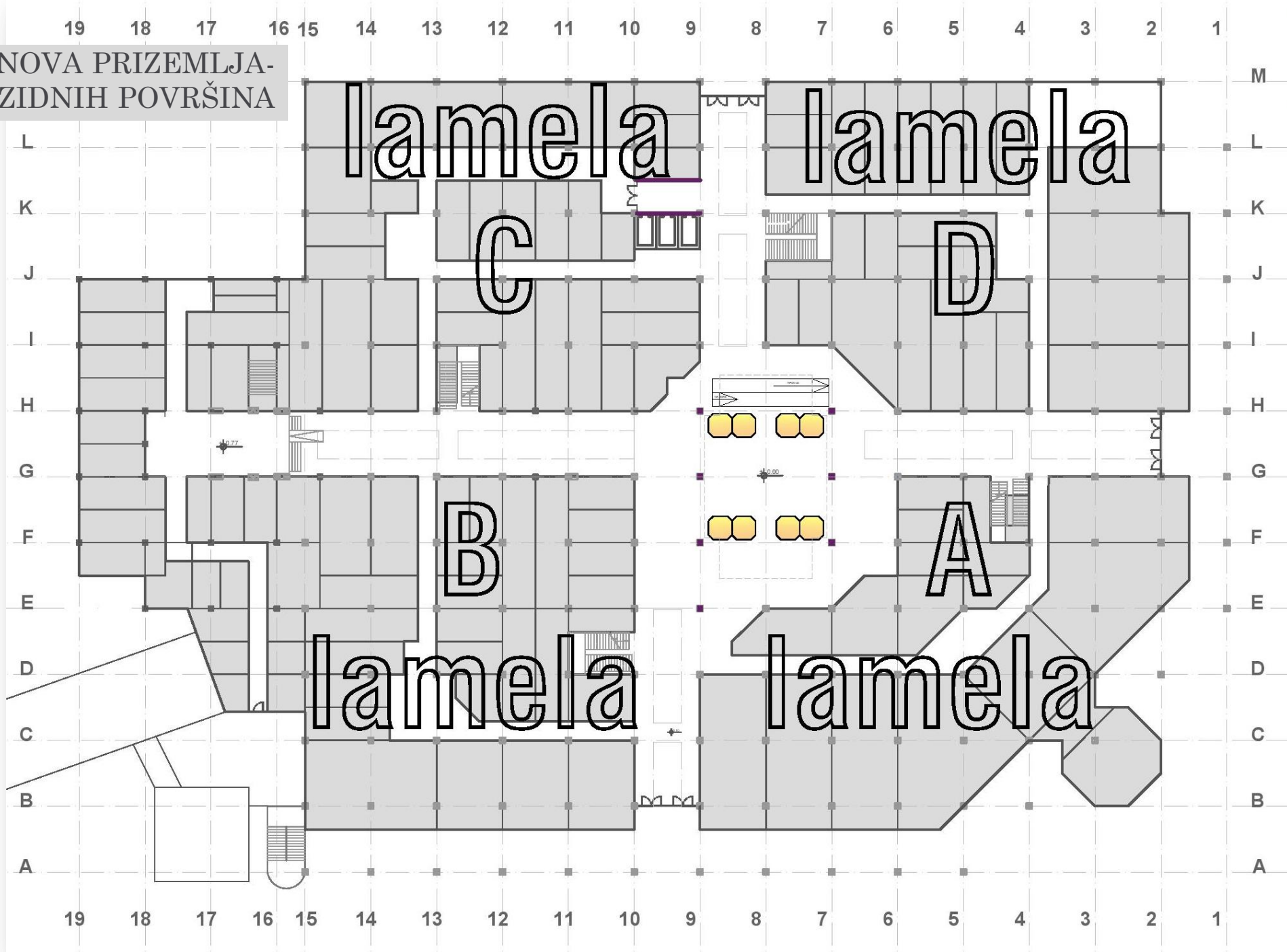

■ Postojeće stubove obložiti gips karton pločama na lepku, sa obavezanim bandažiranjem spojeva i ugaornim lajsnama. Postavljanje tapete 365754 A.S. Designdschungel by Laura N.

■ Površine obložiti tapetom 365754 A.S. Designdschungel by Laura N. prema 3D prikazima

Napomena:
Ostale površine kao i plafon sa odgovarajućom pripremom boji u RAL 9010 prema 3D prikazima

Maske eskalatora boji polikuretanskom bojom u RAL 9010 sa odgovarajućom pripremom.

Vrata liftova boji polikuretanskom bojom RAL 1036.

Novoprojektovani unutrašnji pregradni portal dimenzije 400x320 na poziciji lamela C kod lišta boji u u RAL 9011.



3D PRIKAZ

POGLED 1



POGLED 2



POGLED 3





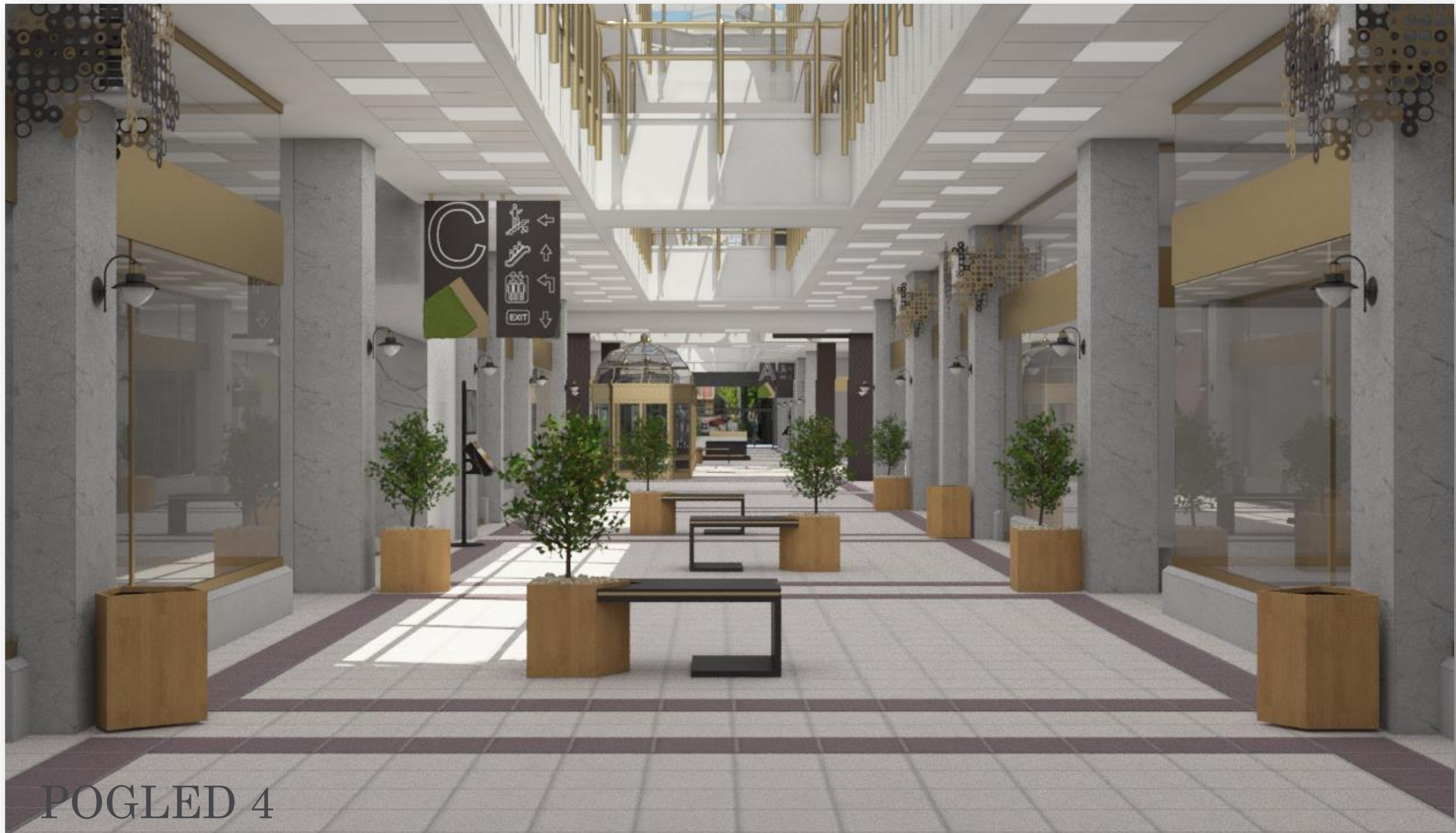

POGLED 4



POGLED 6





POGLED 8



LINK ZA VIRTUELNI OBILAZAK

[HTTPS://VIZOR.IO/DRAFT/9AFEGSZCxM
6K/?FBCLID=IWAR1sL5TkTFH3ERK-
1NT3KYUVDxUyB4LLK2F8KzAN_4H
K5FVTPF_3KtWU-6Y](https://vizer.io/draft/9afegszcxm6k/?fbclid=IwAR1sL5TkTFH3ERK-1NT3KYUVDxUyB4LLK2F8KzAN_4HK5FVTPF_3KtWU-6Y)

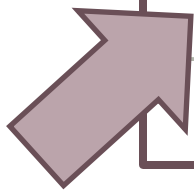

KLIK

**UREĐENJE
PROSTORA KOD
LIFTA-
PRIZEMLJE**

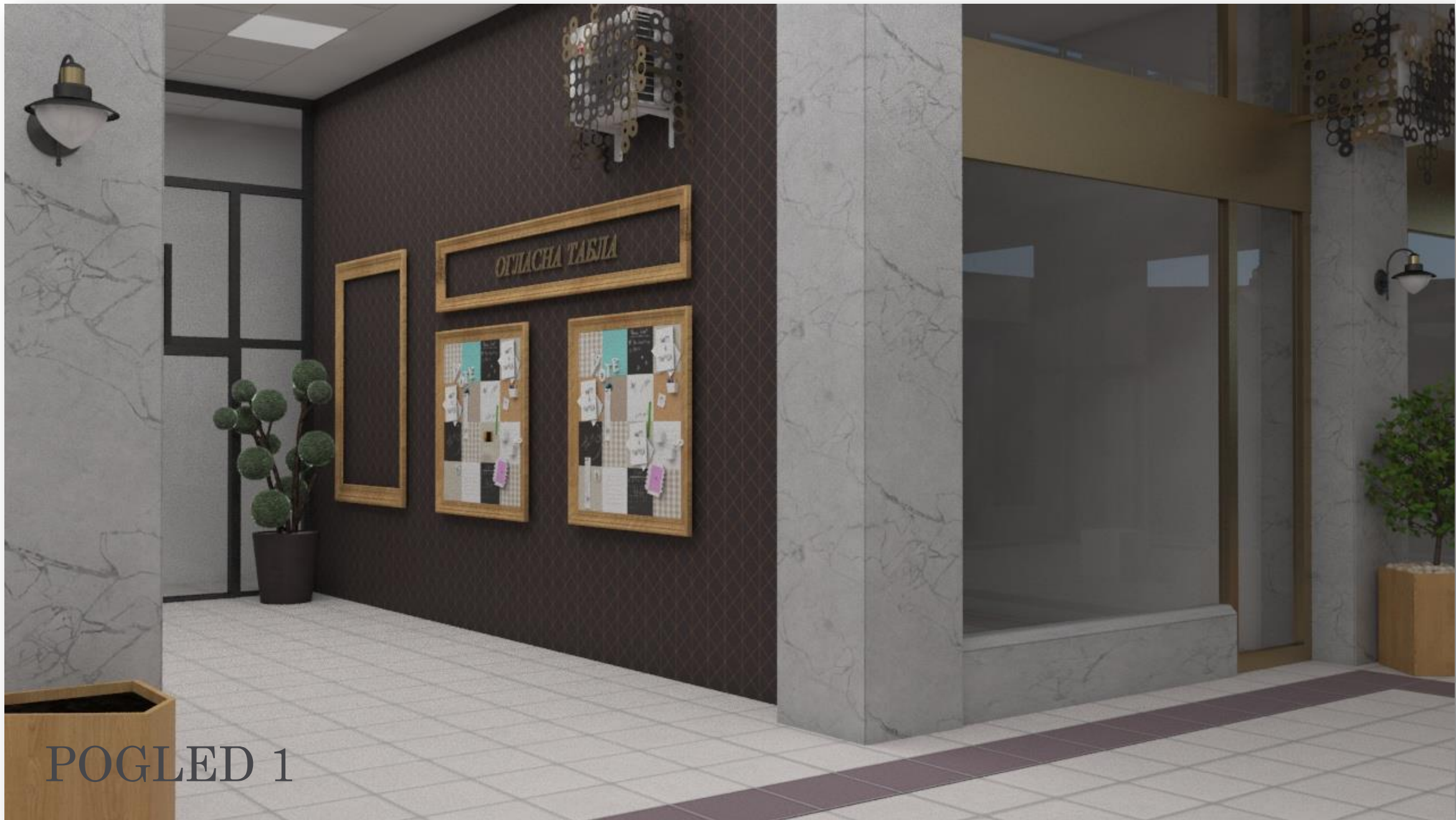

POGLED 1



POGLED 2

NAMEŠTAJ I OPREMA

N1 Osnova

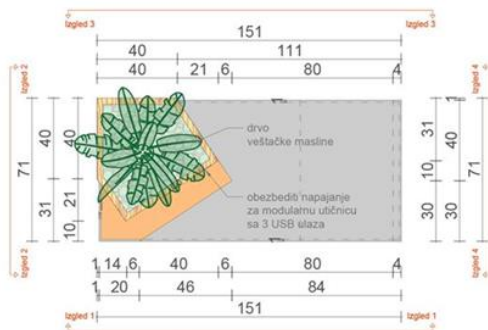

Izgled 1

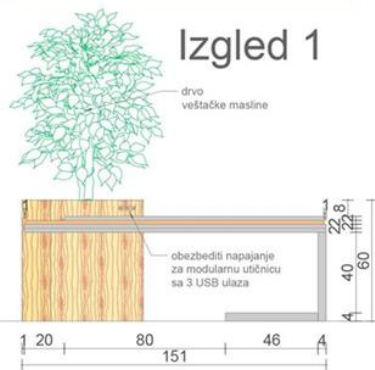

Izgled 2

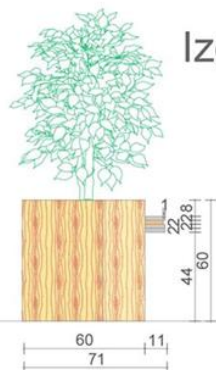

Izgled 3

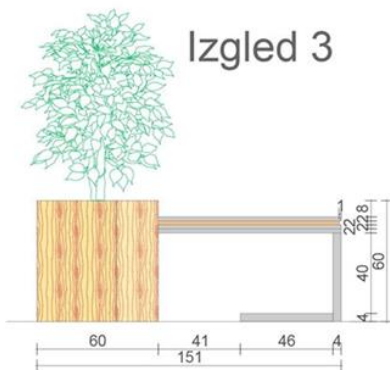

Izgled 4

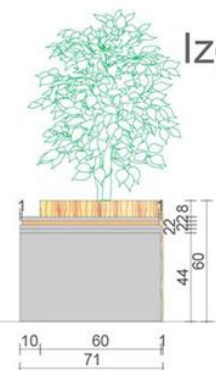

3D prikaz N1



-  IVERICA EGGER U963 ST9
-  IVERICA EGGER UNIVER METALIK ZLATNA F571 ST2
-  IVERICA EGGER H3395 ST12

„ZELENA“ KLUPA
N1

NAPOMENA:
SVE MERE PROVERITI NA LICU MESTA



PRODAJNI PULT N2

N2 Osnova

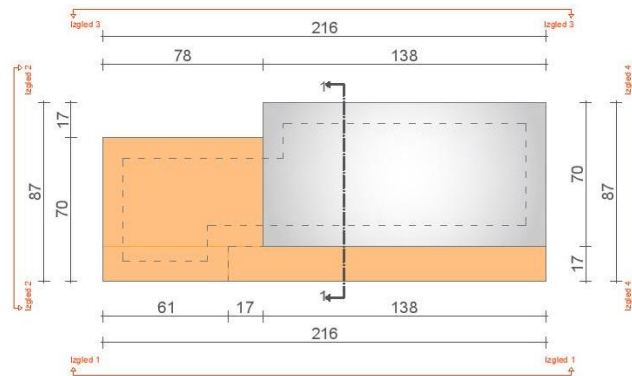

Izgled 1

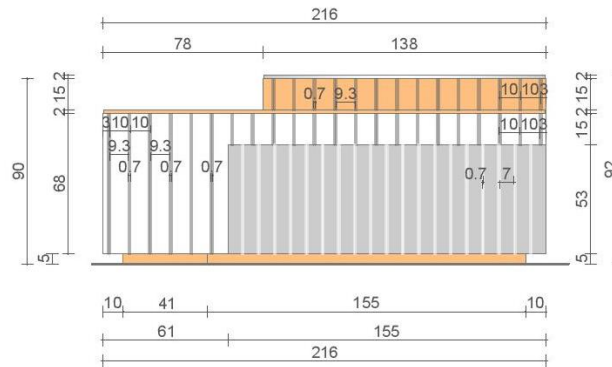

Izgled 3

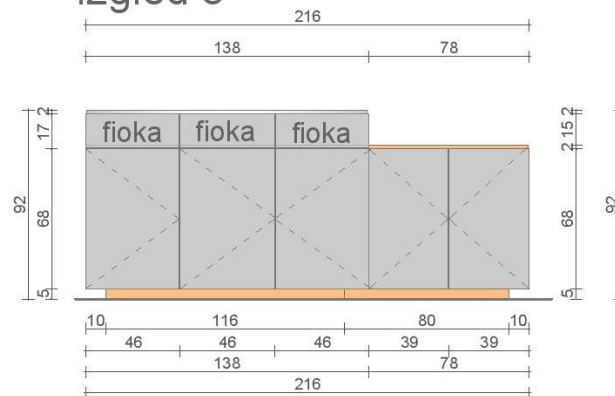

Presek 1-1

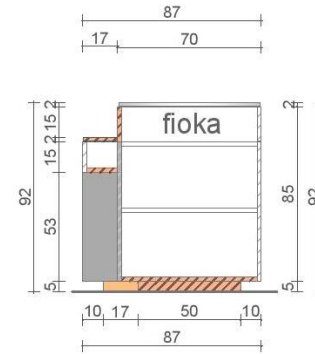

Izgled 2

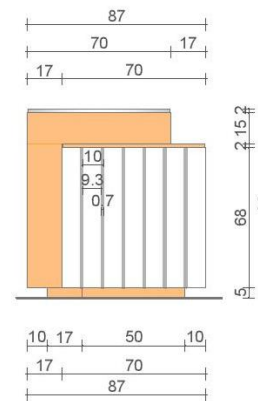



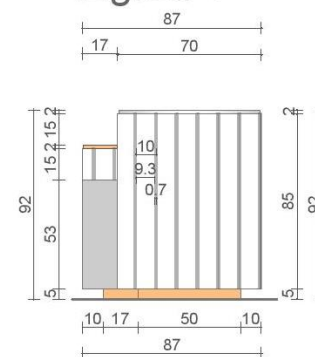



Izgled 4

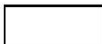

3D prikaz N2

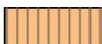

-  IVERICA EGGER U963 ST9
-  IVERICA EGGER UNIVER METALIK ZLATNA F571 ST2
-  IVERICA EGGER W1000 ST9
-  MEDIJAPAN BOJE NAJSLSIČNIJE BOJI EGGER W1000 ST9
-  MEDIJAPAN BOJE NAJSLSIČNIJE BOJI IVERICE EGGER UNIVER METALIK ZLATNA F571 ST2
-  MEDIJAPAN BOJE NAJSLSIČNIJE BOJI IVERICE EGGER U963 ST9

NAPOMENA:
SVE MERE PROVERITI IN

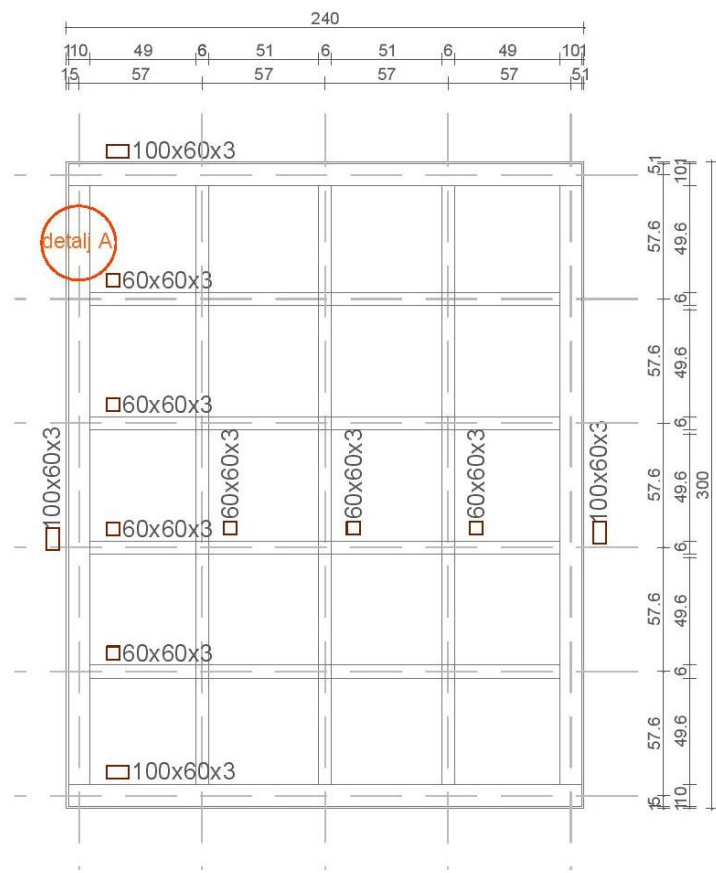

Detalj A

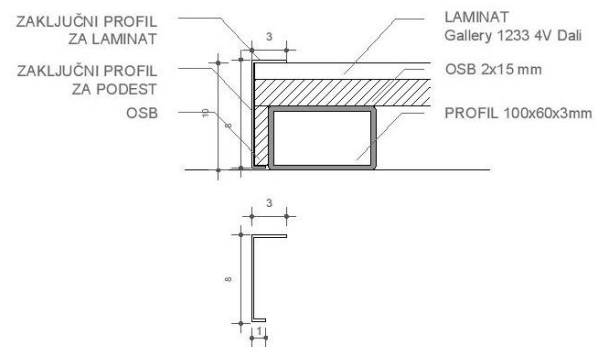

KONSTRUKCIJA PODIJUMA ZA PRODAJNE PULTOVE

NAPOMENA:
SVE MERE PROVERITI NA LICU MESTA



ORJENTACIONE TABLE N3

N3 Osnova

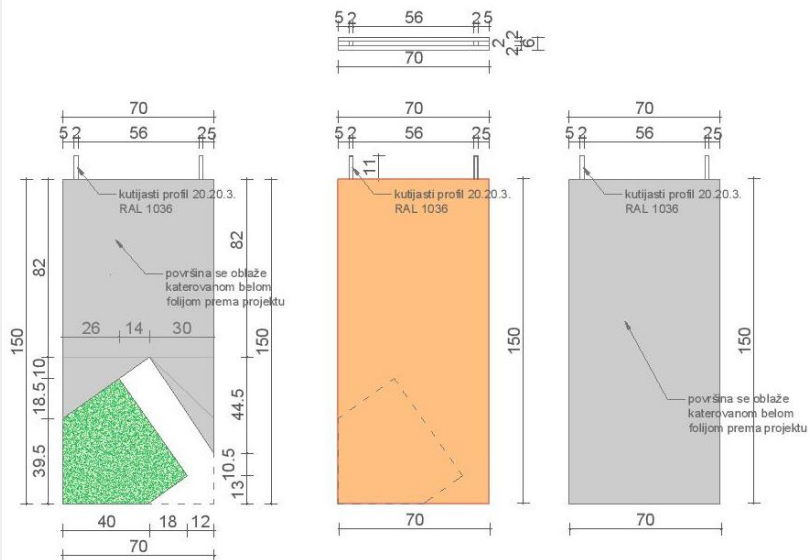

Ploča 1

Ploča 2

Ploča 3

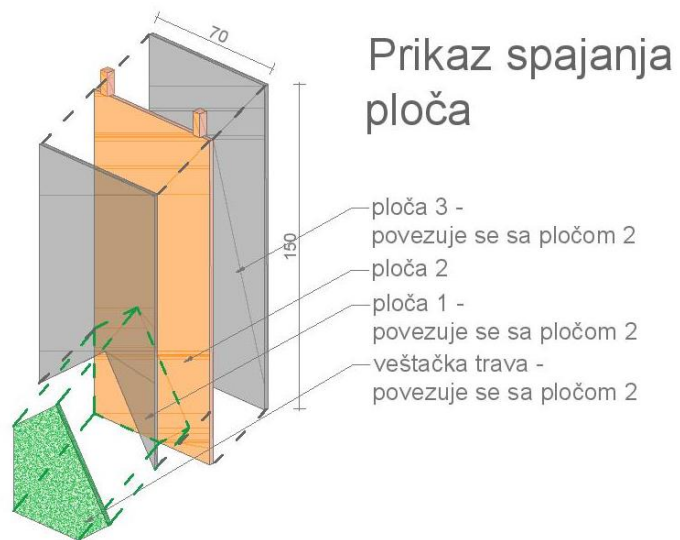

Prikaz spajanja
ploča

3D prikaz primera N3 sa katerovanom belom folijom



N4 Osnova

PLASTIFICIRANI ČELIK
boja RAL 7022

IVERICA EGGER H3395 ST12

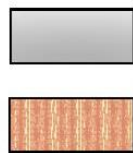
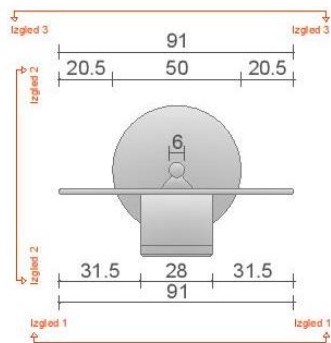

Izgled 2

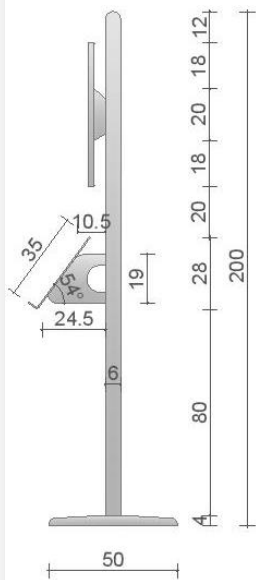

Izgled 1

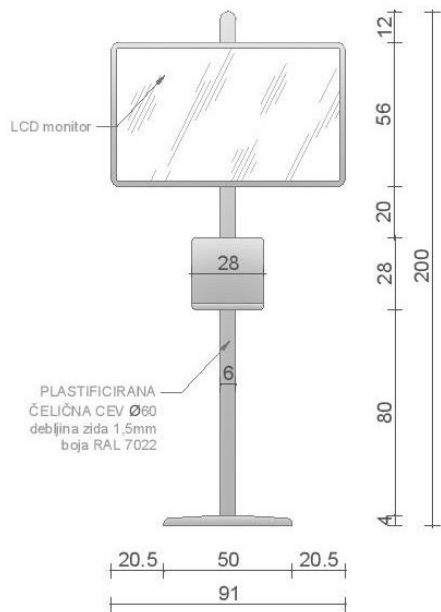

Izgled 3

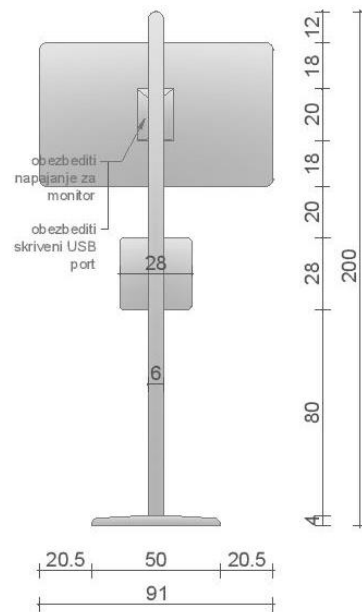

N5 Izgled 1

Izgled 2

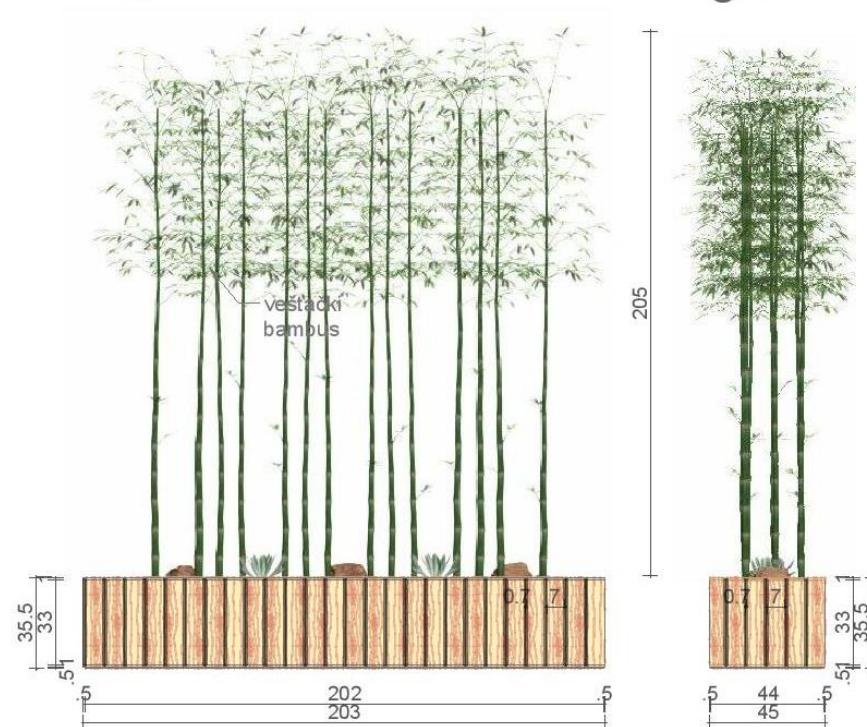

Osnova



TPACIRANI ELEMENTI ZA SEDENJE N6 I N7

N6

Osnova

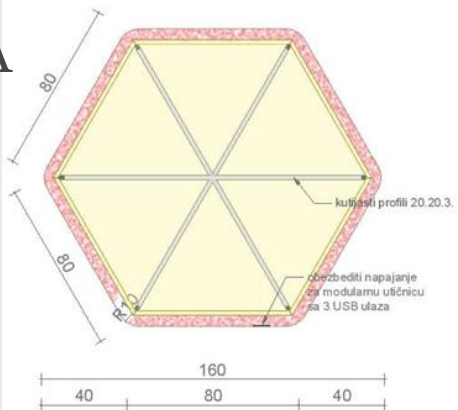

Izgled

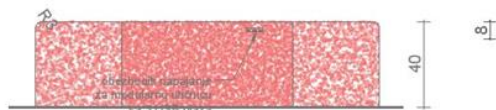

Presek

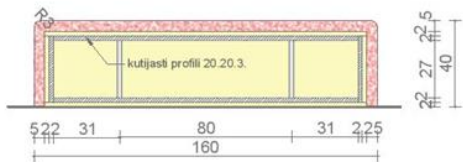

N7

Osnova

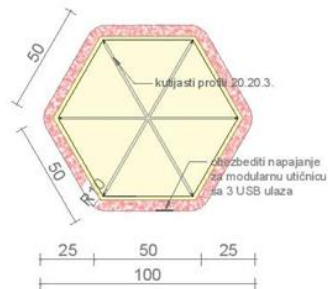

Izgled



Presek

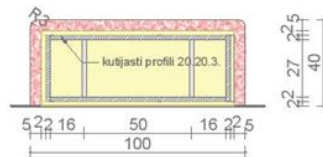

3D prikaz
N6 i N7



N8

Osnova

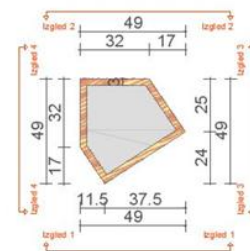

Izgled 1

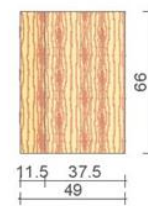

Izgled 2

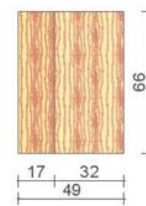

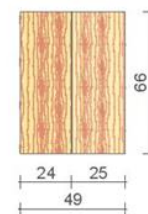

Izgled 3

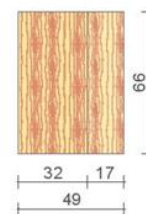

Izgled 4

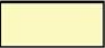

-  OSB ploča
-  MEBL MERCIS BOMBAY 73
-  LIM
-  IVERICA EGGER H3395 ST12

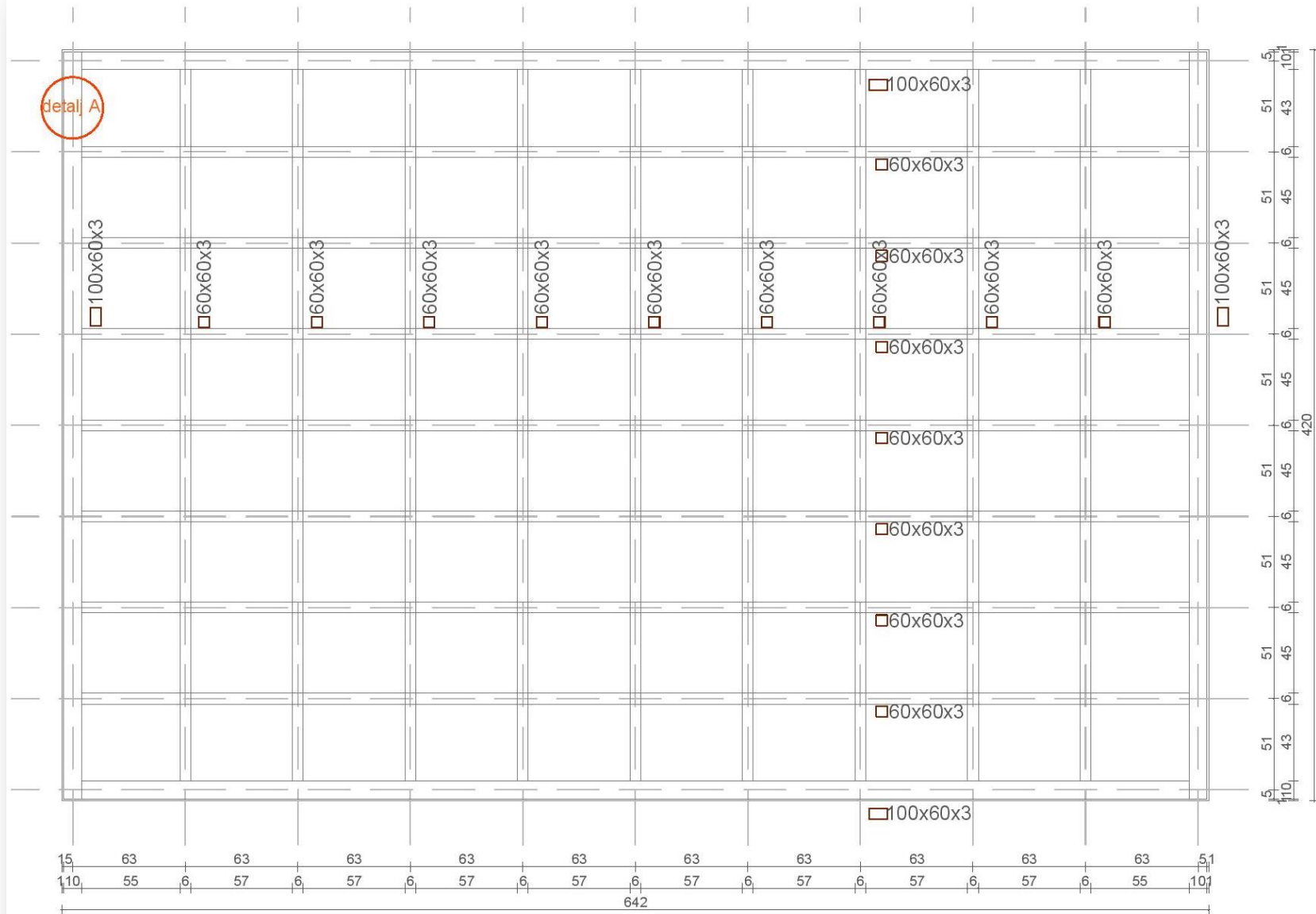

Detalj A

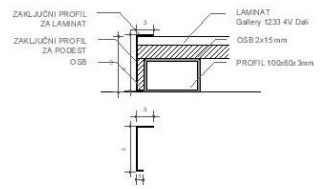

KONSTRUKCIJA PODIJUMA ZA PRODAJNE PULTOVE

NAPOMENA:
SVE MERE PROVERITI NA LICU MESTA



N9

Osnova

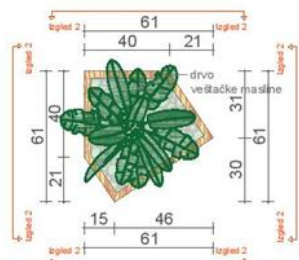

Izgled 1

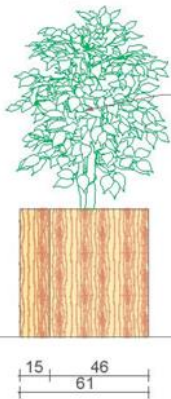

Izgled 2

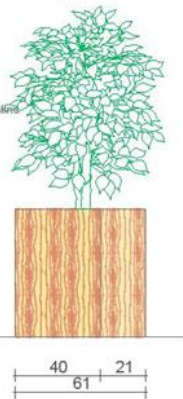

Izgled 3

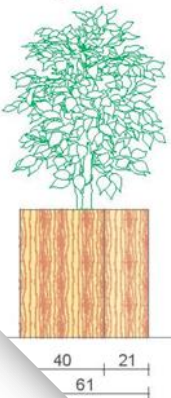

Izgled 4

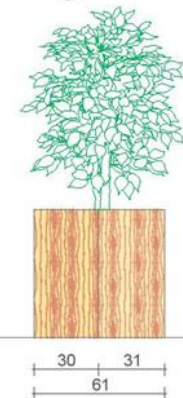

N11 Osnova

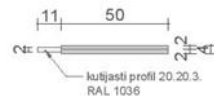

Izgled ploča

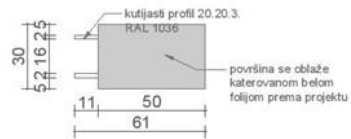

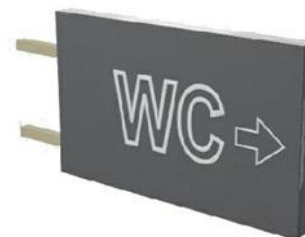

3D prikaz N11

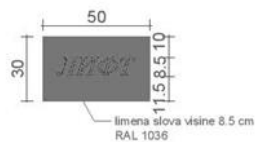

N15



-  PLASTIFIKACIJA
boja RAL 7022
-  IVERICA EGGER U963 ST9
-  PLUTA
-  IVERICA EGGER H3395 ST12

N14

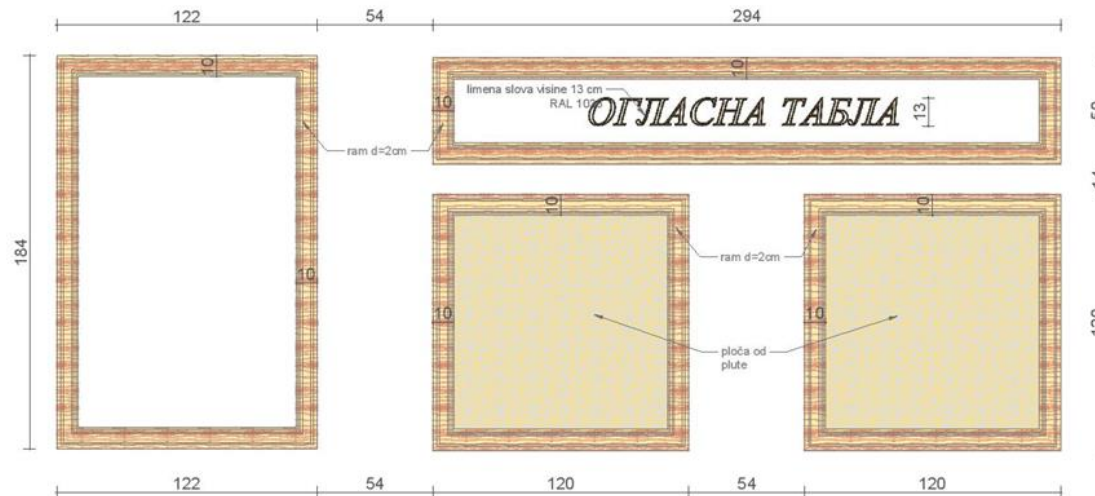

Osnova N10

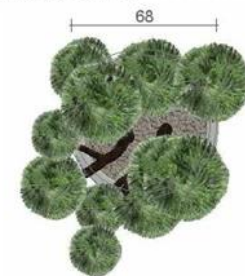

Izgled



N13

Osnova

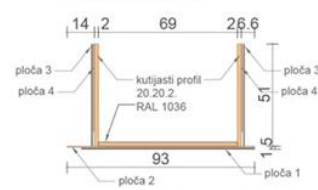

Izgled ploče 1

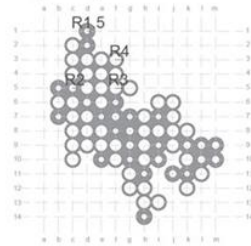

Izgled fronta

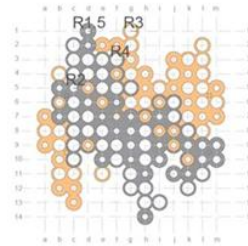

Izgled ploče 2

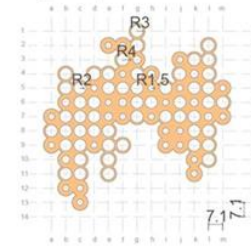

Izgled ploče 3

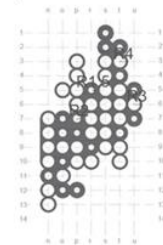

Izgled bočne strane

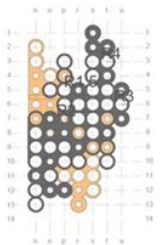

Izgled ploče 4

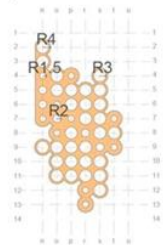

PLASTIFICIRANI LIM d=0,7mm
ili deblji po potrebi
BOJA RAL 1036



PLASTIFICIRANI LIM d=0,7mm
ili deblji po potrebi
BOJA RAL 7022

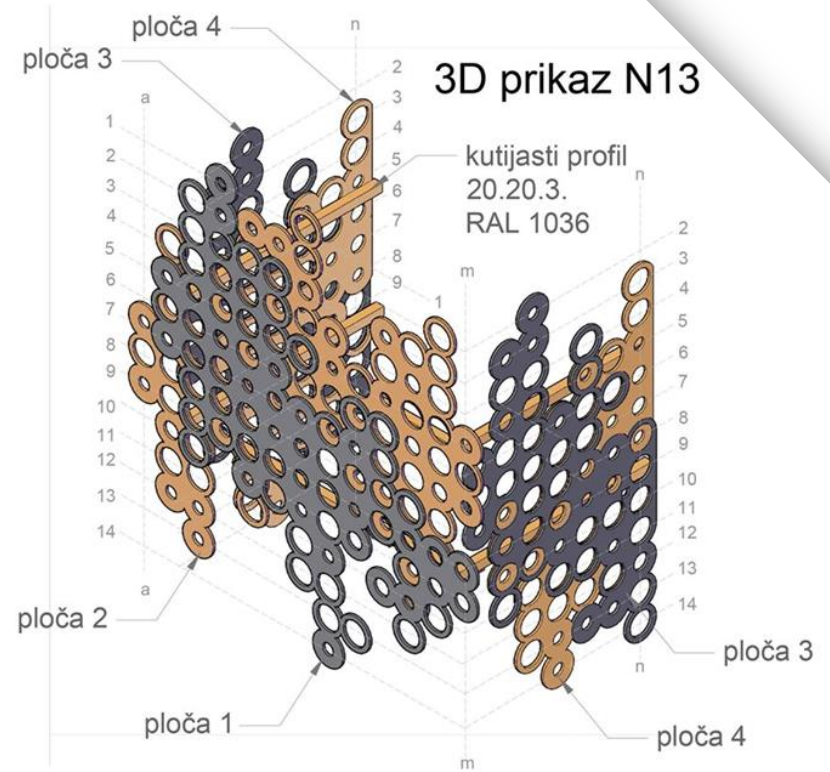

Napomena:

N13 postavljati po potrebi. Dimenzije i izgled modifikovati prema dimenzijama spoljašnje jedinice klime uz konsultaciju sa projektantima.

KONSTRUKCIJA PODIJUMA ZA PRODAJNE PULTOVE

NAPOMENA:
SVE MERE PROVERITI NA LICU MESTA



**PREDLOG
ORGANIZACIJE
PROSTORA ZA
MODNE REVIJE**

POGLED 1



POGLED 2



HVALA

ARHITEKTURA I DEKOR STUDIO

https://vizor.io/draft/9AfeGsZCxM6K/?fbclid=IwAR1sL5TkTFh3erK-1NT3KyuvDxUyb4L1k2f8KzaN_4HK5FVtPF_3KtwU-6Y